



# FF-260PA



Precious metal-brush motors

OUTPUT : 0.5W~3.0W (APPROX)

WEIGHT : 37g (APPROX)

Typical Applications Home Appliances : Electric Shaver

MODEL		VOLTAGE		NO LOAD		AT MAXIMUM EFFICIENCY				STALL			
		OPERATING RANGE	NOMINAL	SPEED r/min	CURRENT A	SPEED r/min	CURRENT A	TORQUE mN-m	TORQUE g-cm	OUTPUT W	TORQUE mN-m	TORQUE g-cm	CURRENT A
FF-260PA-4032	(*1)	1.0~1.5	1.2V CONSTANT	6900	0.26	5910	1.55	1.97	20.1	1.22	13.7	140	9.20
FF-260PA-3057	(*1)	1.5~3.5	2.4V CONSTANT	7800	0.15	6790	1.01	2.39	24.3	1.69	18.4	188	6.75
FF-260PA-10390	(*1)	10~15	15V CONSTANT	7100	0.023	6000	0.13	1.91	19.5	1.20	12.3	125	0.68

(\*1) CW shifted commutation (CW+)

CW+

## DIRECTION OF ROTATION

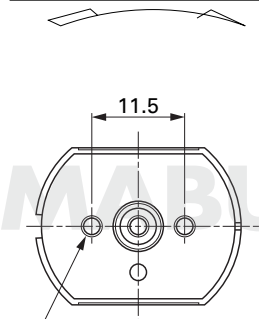

M2.6X0.45 TAPPED HOLE  
2 PLACES

Usable machine screw length 2.0 max. from motor mounting surface.

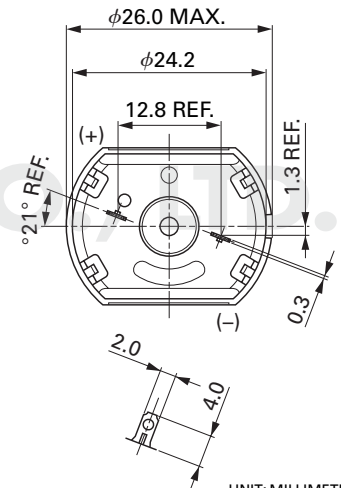
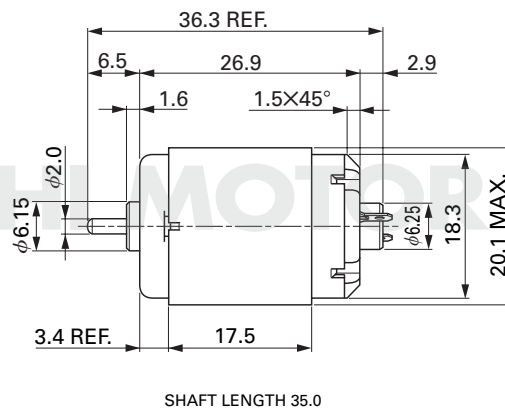

UNIT: MILLIMETERS

### FF-260PA-4032

1.2V

### FF-260PA-3057

2.4V

